

EAST AREA COMMITTEE MEETING – 6TH JUNE 2013

Amendment De-brief Note

PLANNING APPLICATIONS

CIRCULATION: First

ITEM: APPLICATION REF: **12/0095/FUL**

Location: 159-161 Coleridge Road

Target Date: 1st April 2013

To Note:

The applicant has submitted details of a car parking survey for Ashbury Close (see attached information). The applicant has surveyed the level of vacant spaces within Ashbury Close (marked and on-street spaces) and the number of cars parked in the turning head area and adjacent to the applicant's garage.

The survey covers the period from 15 February to 5 May. The applicant has attempted to survey the car parking spaces three times a day to demonstrate the level of car parking provision during the morning, afternoon and evening times.

The applicant suggests that the survey demonstrates that there is sufficient car parking capacity within Ashbury Close to accommodate the loss of car parking in the turning head area, in front of the application site.

I am not able to verify the accuracy of the survey. I do not consider that it provides any reason to alter my recommendation.

Amendments To Text:

Pre-Committee Amendments to Recommendation:

DECISION:

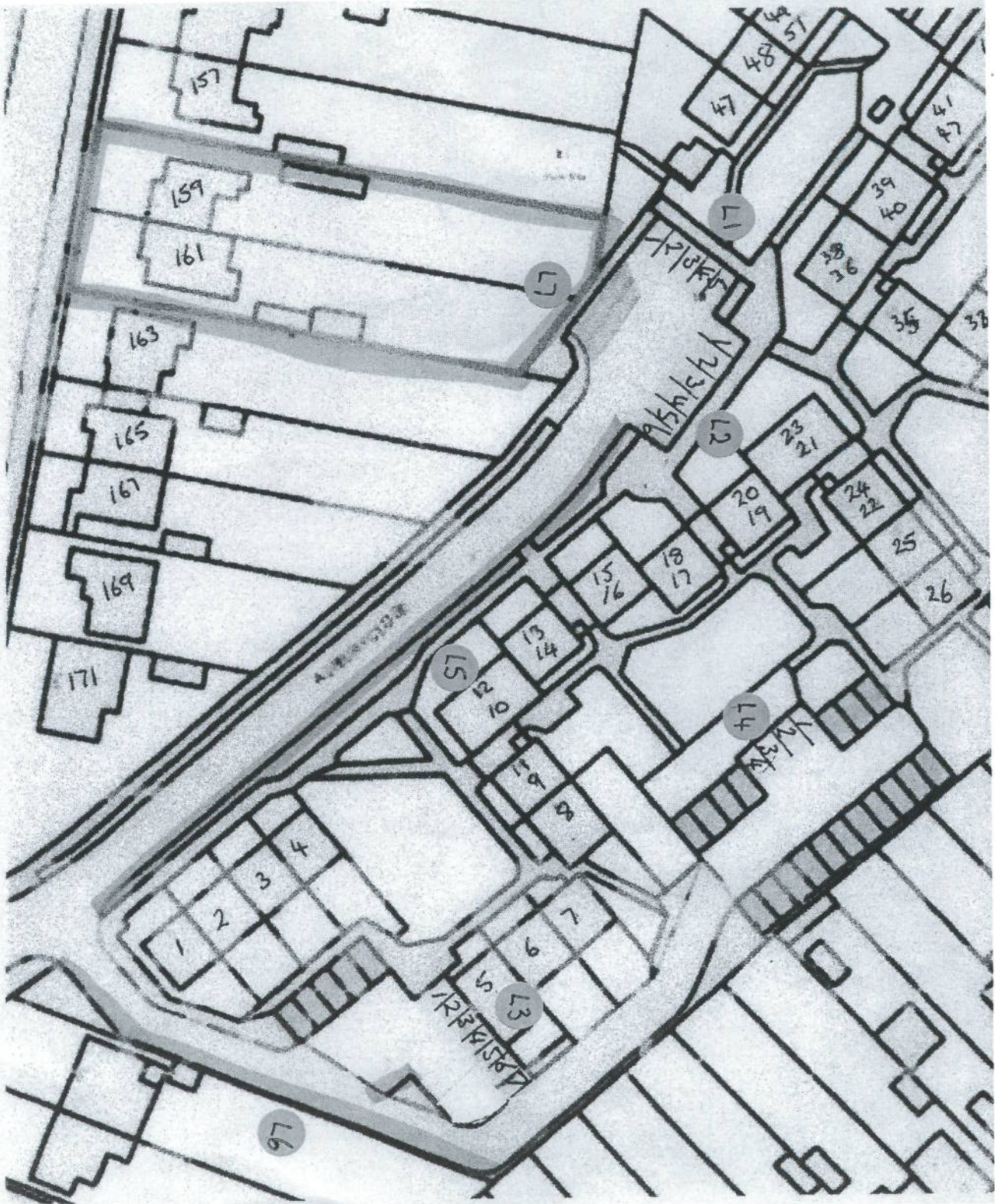

L1, L2, L3, L4 = 22 Formal parking spaces

23 Garages

L5, L6 = 25 On road parking spaces

L7 = Turning Head

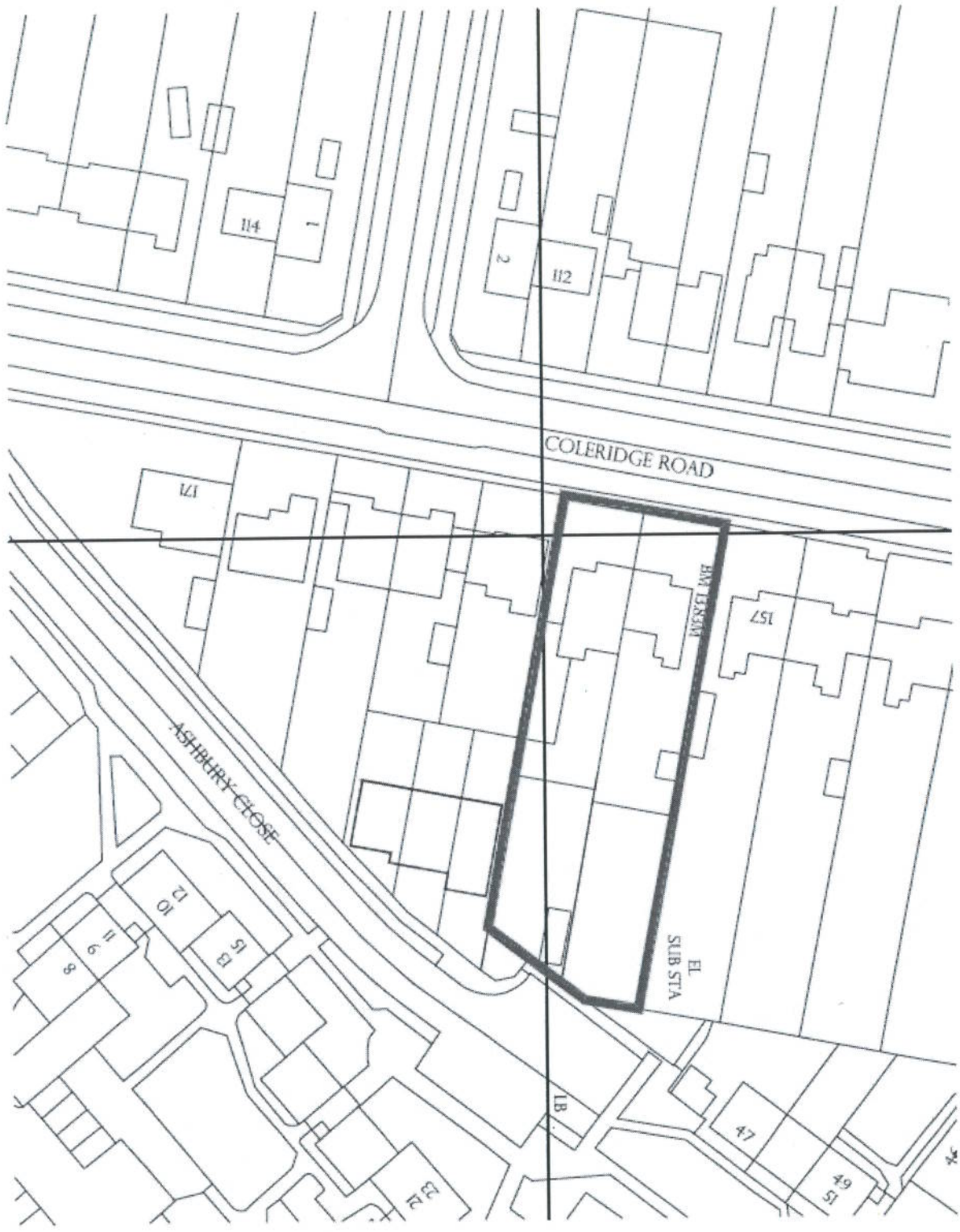

This folder contains:

- A survey carried out at random times between 15 February and 5 May, earliest being 06.15 latest 22.15, showing vacant parking spaces and vehicles parked in the turning head and outside the garage at the rear of 161 Coleridge Road.
- Diagrams showing the locations of parking spaces. There are 22 formal/marked parking spaces, 23 garages and space for 15 cars to park on 1 side of Ashbury Close. There is also space for 10 cars to park on one side of the road leading to the garages, but since carrying out the survey there are seldom any cars using this space.
- Diagrams showing vacant parking spaces which are highlighted in green, and the dates and times of the survey.
- The folder also contains photographic evidence of vacant spaces.

Vacant Spaces					Cars Parked in Turning Head	
Date	Time	Formal/ Marked	On Road	Total	Turning Head	Outside Garage
Friday 15 Feb	07.30	2	11	13	2	1
Saturday 16 Feb	07.30	3	6	9	1	1
Monday 18 Feb	17.15	6	11	17	2	0
Tuesday 19 Feb	15.00	6	11	17	1	0
Wed 20 Feb	09.00	6	13	19	2	1
Friday 22 Feb	06.45	3	10	13	0	0
Friday 22 Feb	13.15	7	11	18	2	0
Friday 22 Feb	19.15	6	10	16	1	0
Saturday 23 Feb	11.35	9	10	19	2	1
Saturday 23 Feb	17.00	8	10	18	2	1
Sunday 24 Feb	07.50	2	9	11	2	1
Sunday 24 Feb	13.00	4	9	13	1	1
Monday 25 Feb	17.30	8	9	17	1	0
Tuesday 26 Feb	06.50	4	7	11	2	0
Tuesday 26 Feb	12.55	10	8	18	2	0
Wed 27 Feb	13.40	9	10	19	2	0
Thursday 28 Feb	06.50	3	7	10	2	1
Thursday 28 Feb	11.45	9	9	18	2	1
Thursday 28 Feb	17.55	4	7	11	3	1
Sunday 3 March	16.50	1	8	9	1	0
Monday 4 March	06.50	1	8	9	2	1
Monday 4 March	12.30	8	10	18	2	0
Tuesday 5 March	17.20	9	9	18	2	0
Wed 6 March	17.20	7	10	17	0	0
Thursday 7 March	06.45	4	9	13	0	0
Thursday 7 March	16.40	8	11	19	0	0
Friday 8 March	06.55	6	8	14	2	1
Friday 8 March	17.35	11	8	19	0	0
Saturday 9 March	06.30	3	9	12	2	1
Saturday 9 March	21.30	4	5	9	4	1
Sunday 10 March	22.00	2	9	11	2	0
Monday 11 March	20.00	7	10	17	1	0
Tuesday 12 March	21.20	5	7	12	2	1
Wed 13 March	21.15	7	8	15	2	0
Thurs 14 March	06.25	3	7	10	1	0
Monday 1 April	19.30	7	9	16	2	0
Tuesday 2 April	19.30	7	7	14	2	0
Wed 3 April	19.30	5	9	14	2	0
Thursday 4 April	19.15	7	7	14	0	0
Friday 5 April	19.40	7	11	18	0	0
Saturday 6 April	19.40	7	9	16	2	0

Sunday 7 April	19.35	4	6	10		3	0
Thursday 11 April	11.10	7	8	15		3	0
Thursday 11 April	20.00	1	11	12		1	0
Friday 12 April	11.20	9	9	18		4	1
Friday 12 April	19.30	8	9	17		3	0
Saturday 13 April	06.55	5	7	12		4	1
Sunday 14 April	06.40	3	8	11		2	0
Monday 15 April	06.25	3	7	10		2	0
Tuesday 16 April	07.00	2	6	8		2	0
Wed 17 April	07.00	3	6	9		3	0
Thursday 18 April	07.00	4	6	10		3	1
Friday 19 April	07.00	3	6	9		3	1
Sunday 21 April	19.30	3	7	10		3	1
Monday 22 April	17.45	9	9	18		1	0
Tuesday 23 April	06.15	2	9	11		2	1
Tuesday 23 April	21.45	2	9	11		2	0
Wed 24 April	22.15	5	7	12		3	1
Thursday 25 April	06.50	4	7	11		4	1
Friday 3 May	20.20	5	7	12		1	1
Saturday 4 May	20.40	2	7	9		2	0
Sunday 5 May	20.10	9	9	18		2	1

5 Formal Spaces Nr 36, 38, 47, 48	6 Formal Spaces Opp. 19, 20, 21, 22 of which 3 are disabled parking spaces
7 Formal Spaces at side of 5, 6, 7	4 Formal Spaces between garages numbered 24, 25
23 Garages	Space for 15 cars to park on one side of the road in Ashbury Close
There is also space for 10 cars to park on side of road leading to garages. These are not counted on table above as there are seldom any cars parked there.	